

Viste tecniche

Vista frontale

Scala 1:2, quote in mm

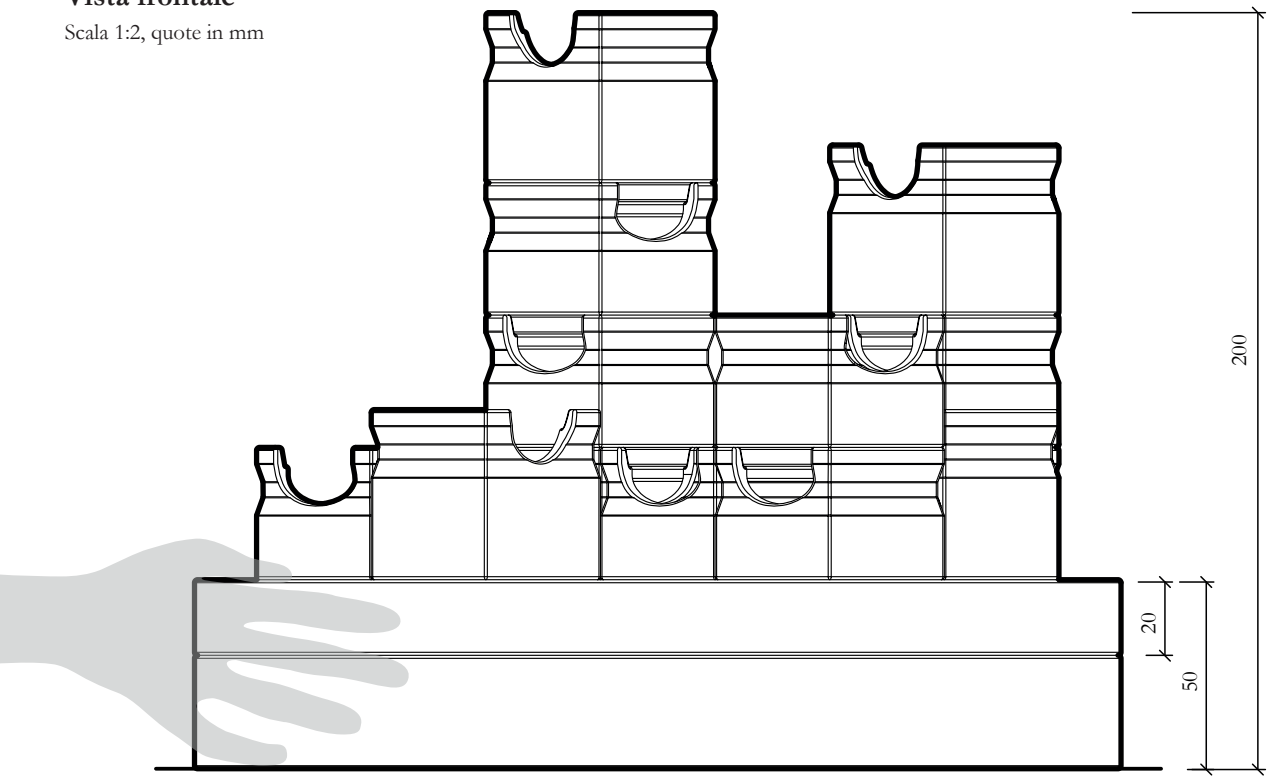

Sezione A-A'

Scala 1:2, quote in mm

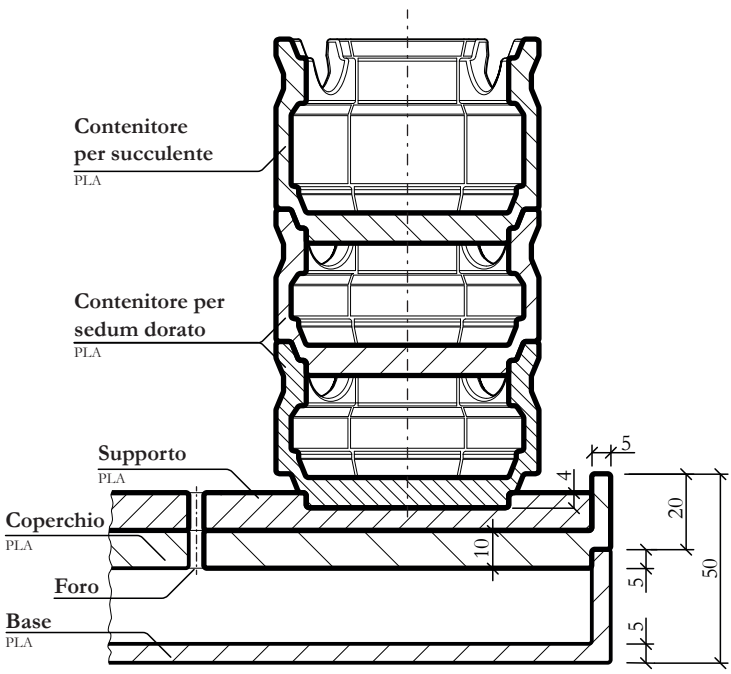

Vista dall'alto

Scala 1:2, quote in mm

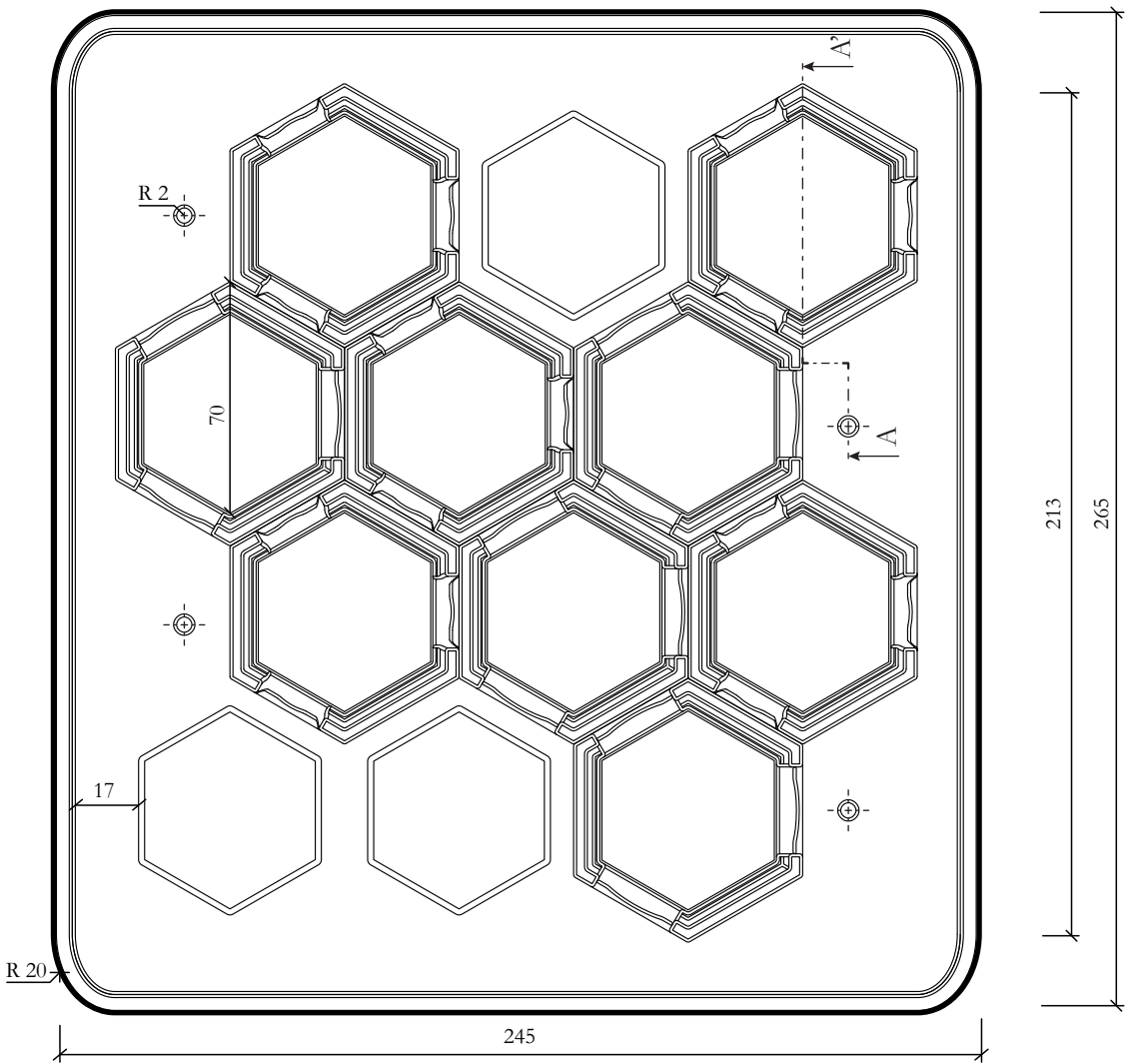

Esploso

Scala 1:5

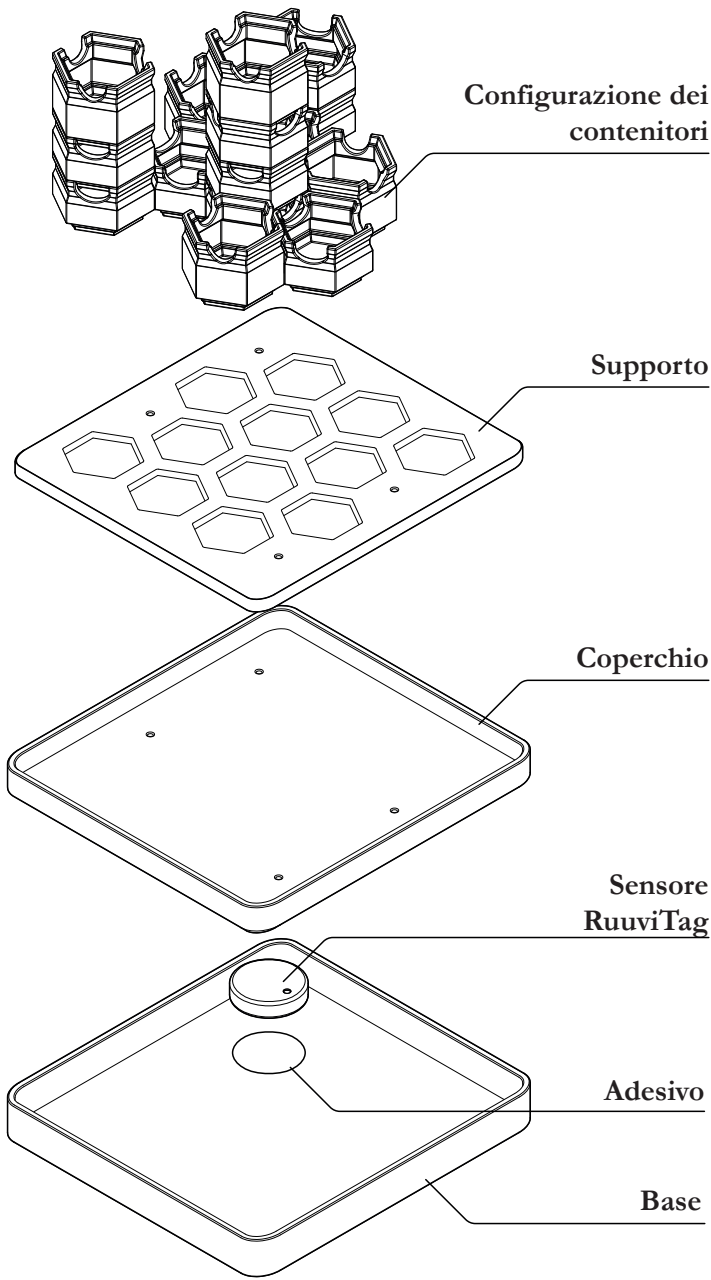

Vista frontale

Contenitore per succulente

Scala 1:2, quote in mm

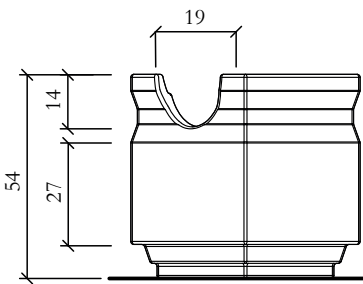

Vista frontale

Contenitore per sedum dorato

Scala 1:2, quote in mm

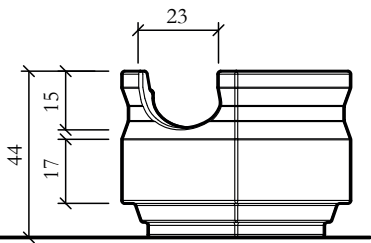

Storyboard d'uso

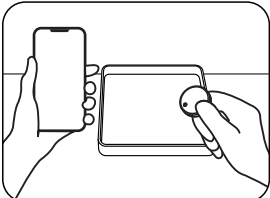

Posiziona il sensore nel fondo della base e collegalo al telefono.

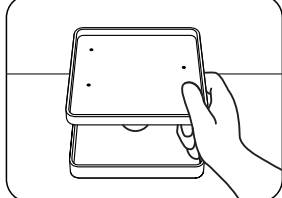

Poni il coperchio sopra la base.

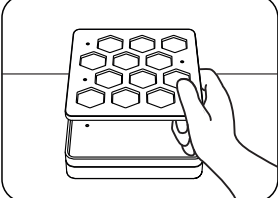

Collocare il supporto sopra al coperchio.

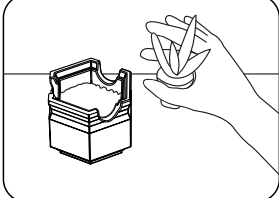

Sistema le piantine e il sedum dentro i relativi contenitori.

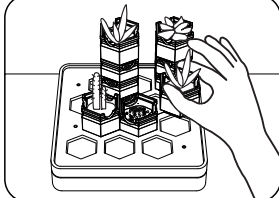

Disponi i contenitori a piacere sul supporto.

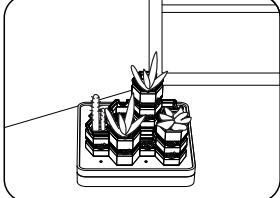

Metti il terrarium KōYA dove vuoi e tranne beneficio.

Viste tecniche

Vista frontale

Scala 1:2, quote in mm

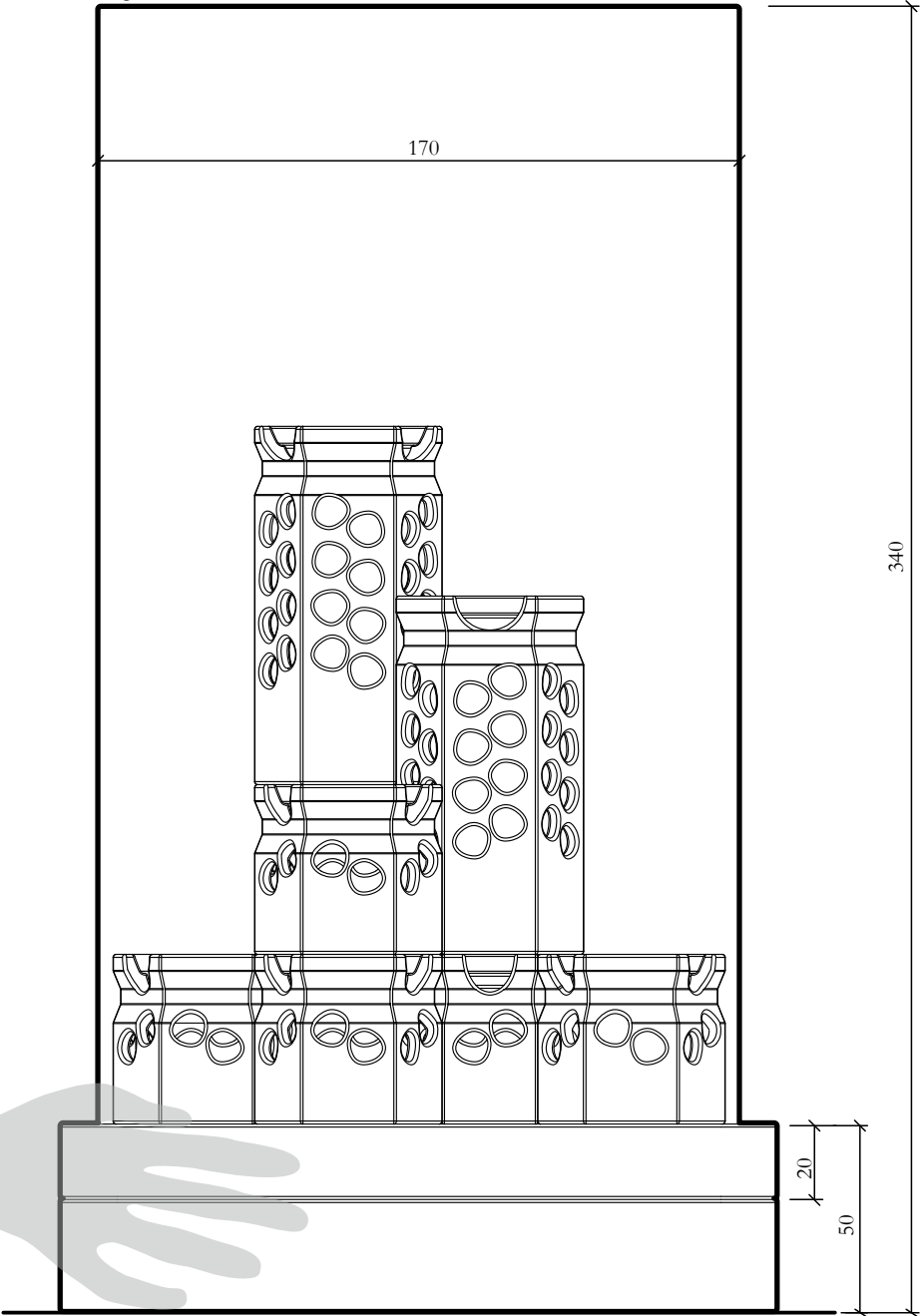

Vista dall'alto

Scala 1:2, quote in mm

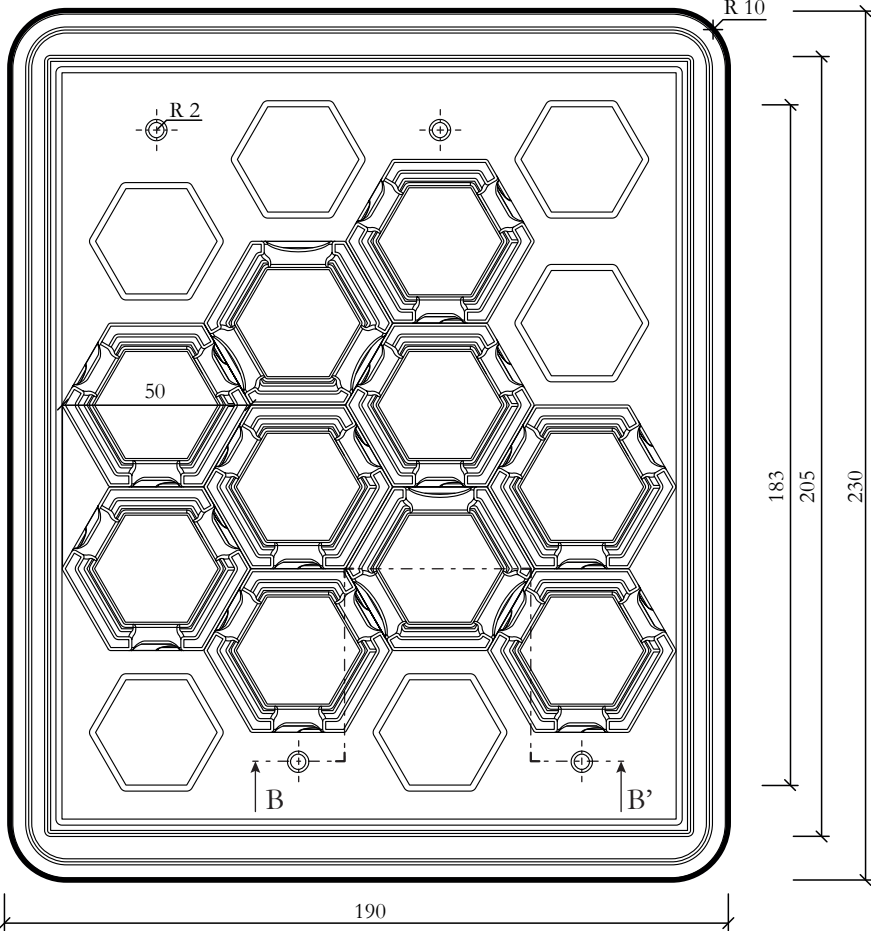

Storyboard d'uso

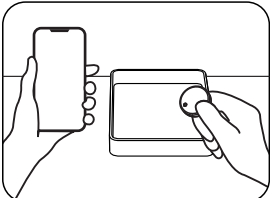

Posiziona il sensore nel fondo della base e collegalo al telefono.

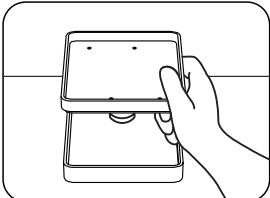

Poni il coperchio sopra la base.

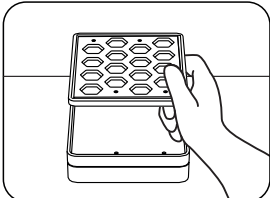

Colloca il supporto sopra al coperchio.

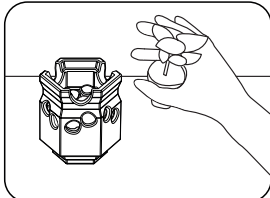

Sistema le piantine e il muschio dentro i relativi contenitori.

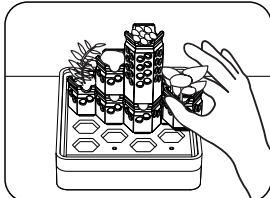

Disponi i contenitori a piacere sul supporto.

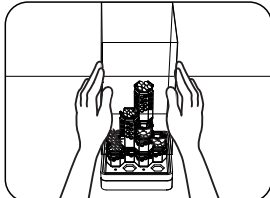

Inserisci la cupola nella scanalatura del supporto.

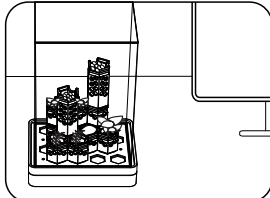

Metti il terrarium NIWA dove vuoi e tranne beneficio.

Sezione B-B'

Scala 1:2, quote in mm

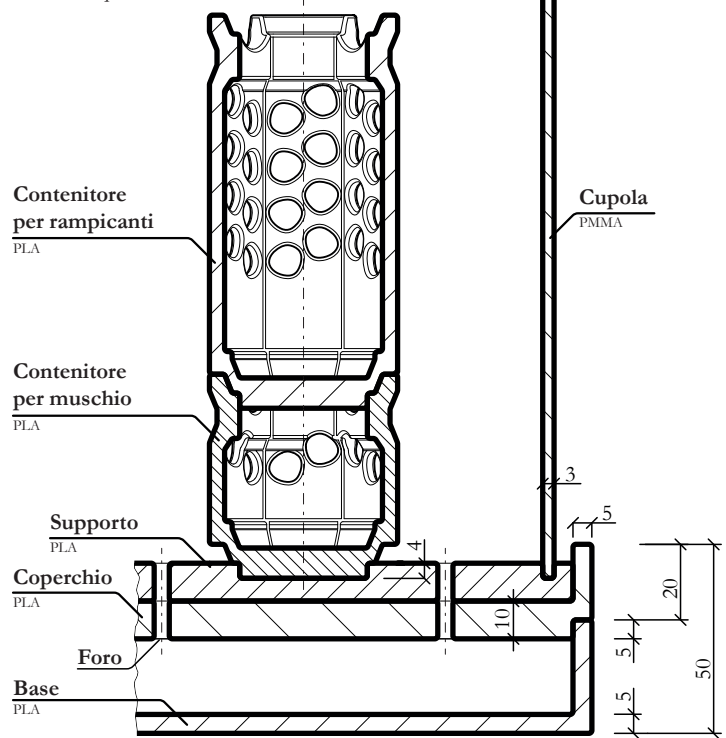

Esploso

Scala 1:5

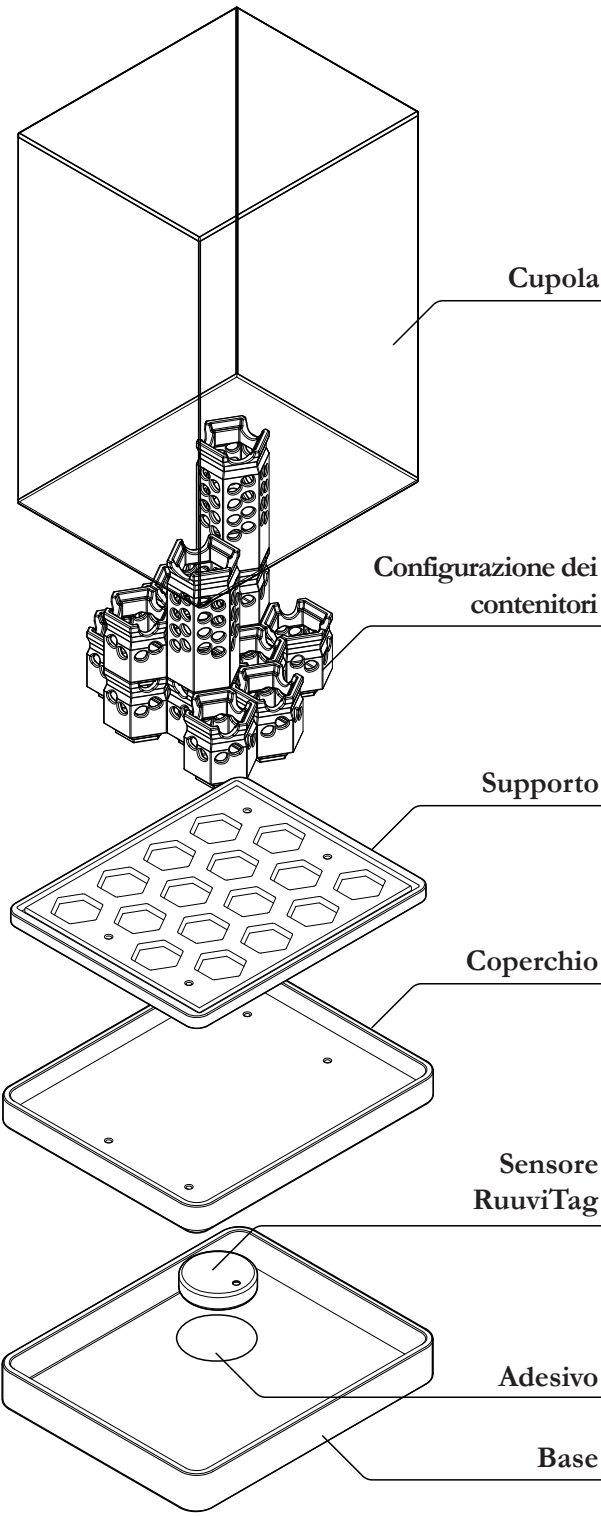

Vista laterale

Contenitore per muschio

Scala 1:1, quote in mm

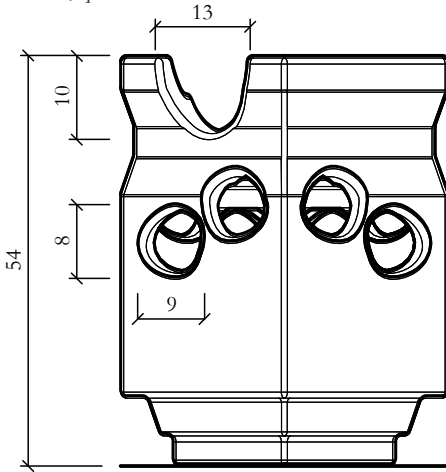

Vista laterale

Contenitore per rampicanti

Scala 1:1, quote in mm

